

abbotFox



Norwich, NR4  
£175,000

“

We are a team of genuine individuals who hold a deep passion for both property and marketing. Collectively, we bring over 70 years of experience in the property market of Norfolk and Suffolk. Our affection for both counties runs deep, and we are enthusiastic about sharing our passion with you.

Colin McKenzie | **Branch Partner**







## THE DETAIL\_\_\_\_\_

abbotFox presents this stylish and superbly located apartment, positioned on the upper floor of the sought-after Uplands Court development including a private ground floor access door leading straight into the apartment—offering the perfect blend of comfort, convenience, and contemporary living.

Light-filled and well presented, this home provides a ready-to-move-into home ideal for first-time buyers, professionals, or investors alike. The spacious living area enjoys an elevated aspect and connects seamlessly to a fitted kitchen, while generous proportions throughout ensure practical living space.

The double bedrooms and shower room have been well maintained to a high standard. Residents also enjoy access to well-maintained communal grounds and private off-road parking.

Set in a desirable residential location with easy access to Norwich city centre, local amenities, and transport links, this is a smart and secure home with strong rental potential and broad appeal.

Agents notes: Water and sewage rates of £214 per annum are all included in the service charge of £760 per annum paid in two instalments.

GUIDE PRICE: £175,000 - £185,000





## THE HIGHLIGHTS\_\_\_\_

- First floor apartment
- Private entrance
- Generous living accommodation
- Two double bedrooms
- Close to local amenities
- Ideal first time buy or investment
- No onward chain
- Viewing advised

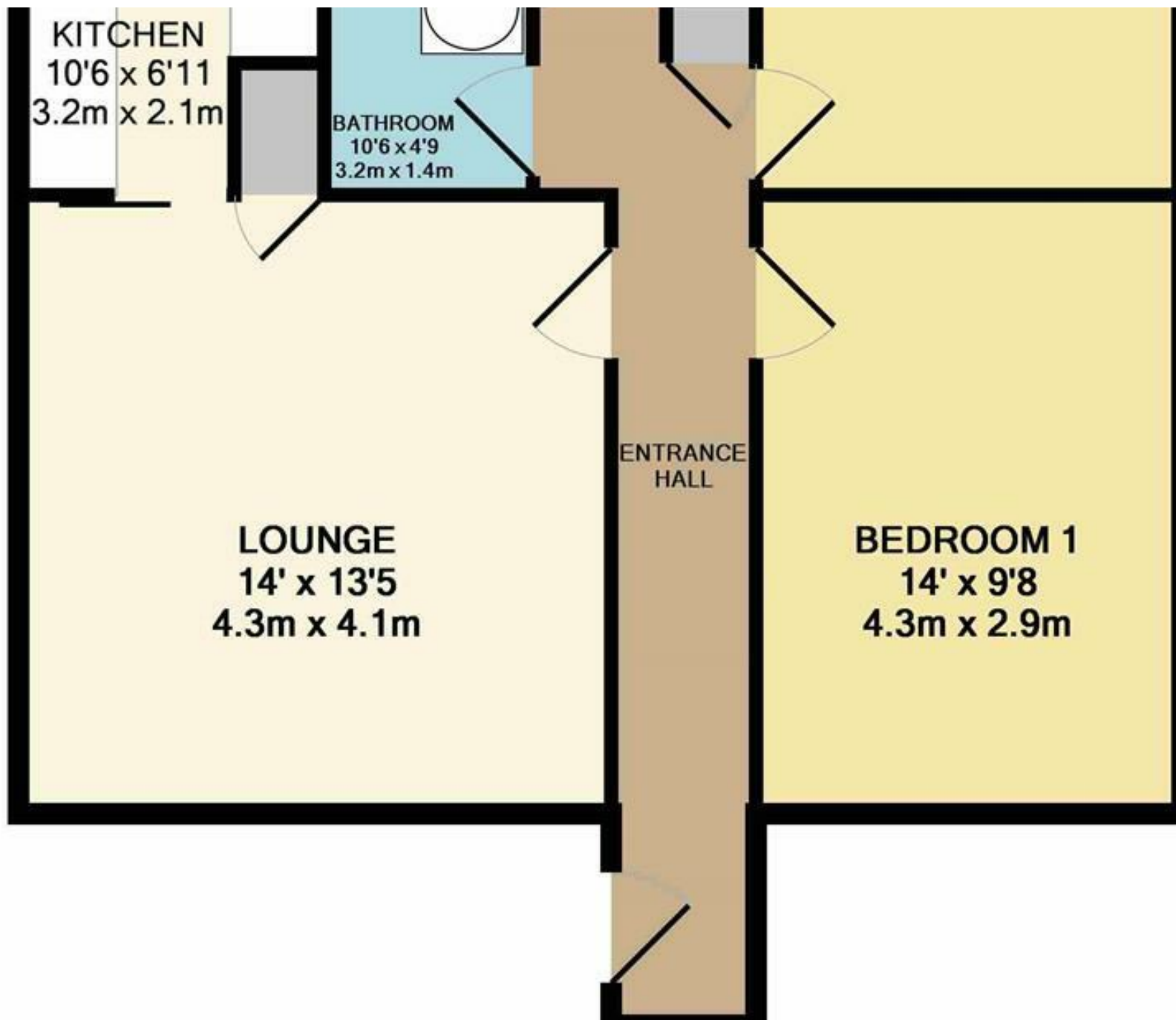

*Let's talk*

01603 660000

[sales@abbotfox.co.uk](mailto:sales@abbotfox.co.uk)

@abbotfox

EPC RATING - C

Disclaimer – In accordance with the Property Misdescriptions Act, the company abbotFox gives notice that all descriptions, references to condition, necessary permissions for use and other details are given in good faith and believed to be correct, but any purchaser should not rely on them as statements of fact, and must satisfy themselves by inspection or other means, as to their accuracy.